

HELP SHAPE THE FUTURE OF DEAN GARDENS

OPPORTUNITIES AND CONSTRAINTS - INSIDE THE PARK

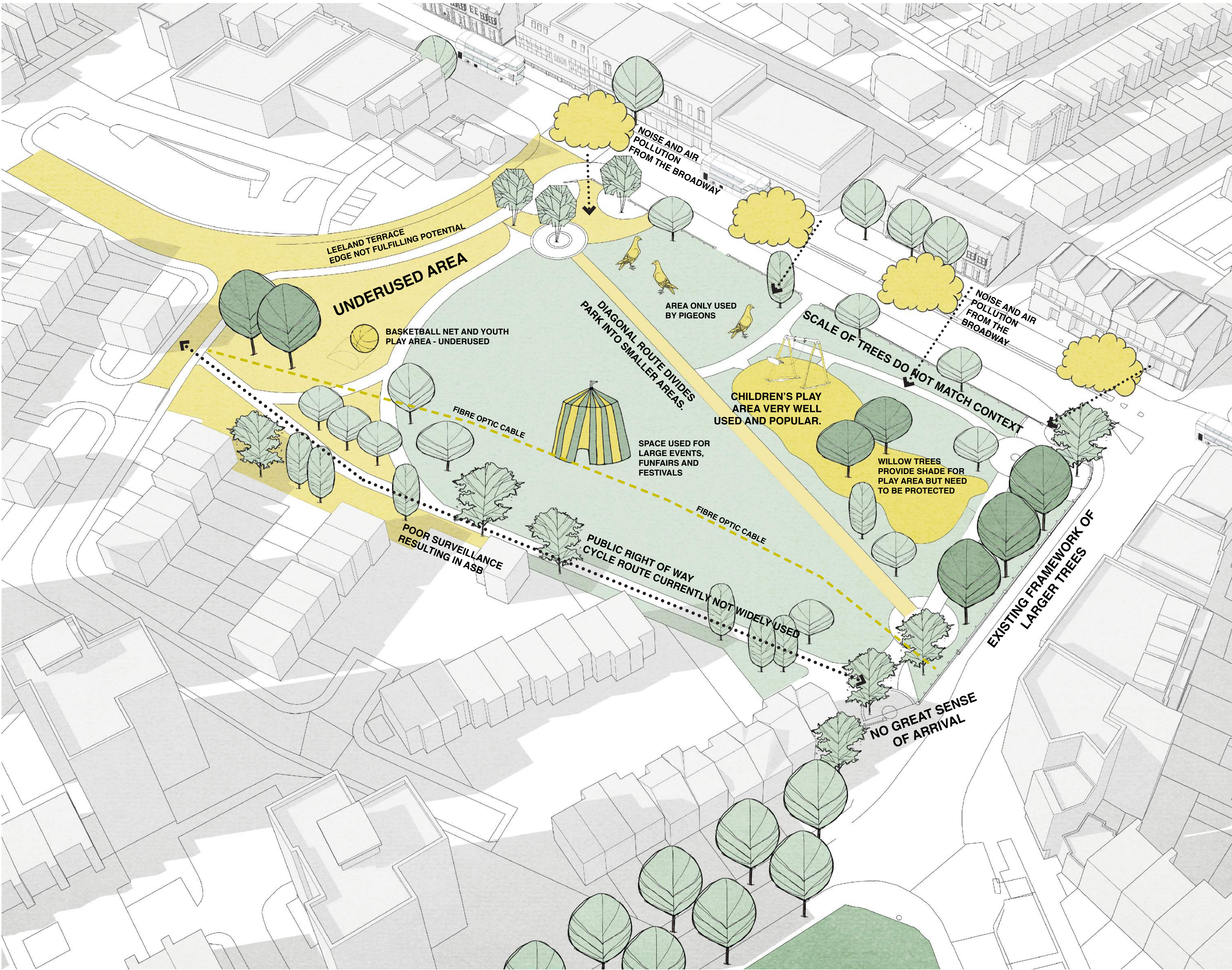

Looking inside the park there are a number of key opportunities that we can build on to ensure Dean Gardens is successfully re-imagined, with a unique and defined character. The following board considers the opportunities to define Dean Gardens.

LIGHTING IN THE PARK

Lighting in the park will play a very important role in it's safety and how it is used in the evenings/after dark. Lighting should clarify the layout of a park by emphasizing routes, focal points, gathering places and entrances.

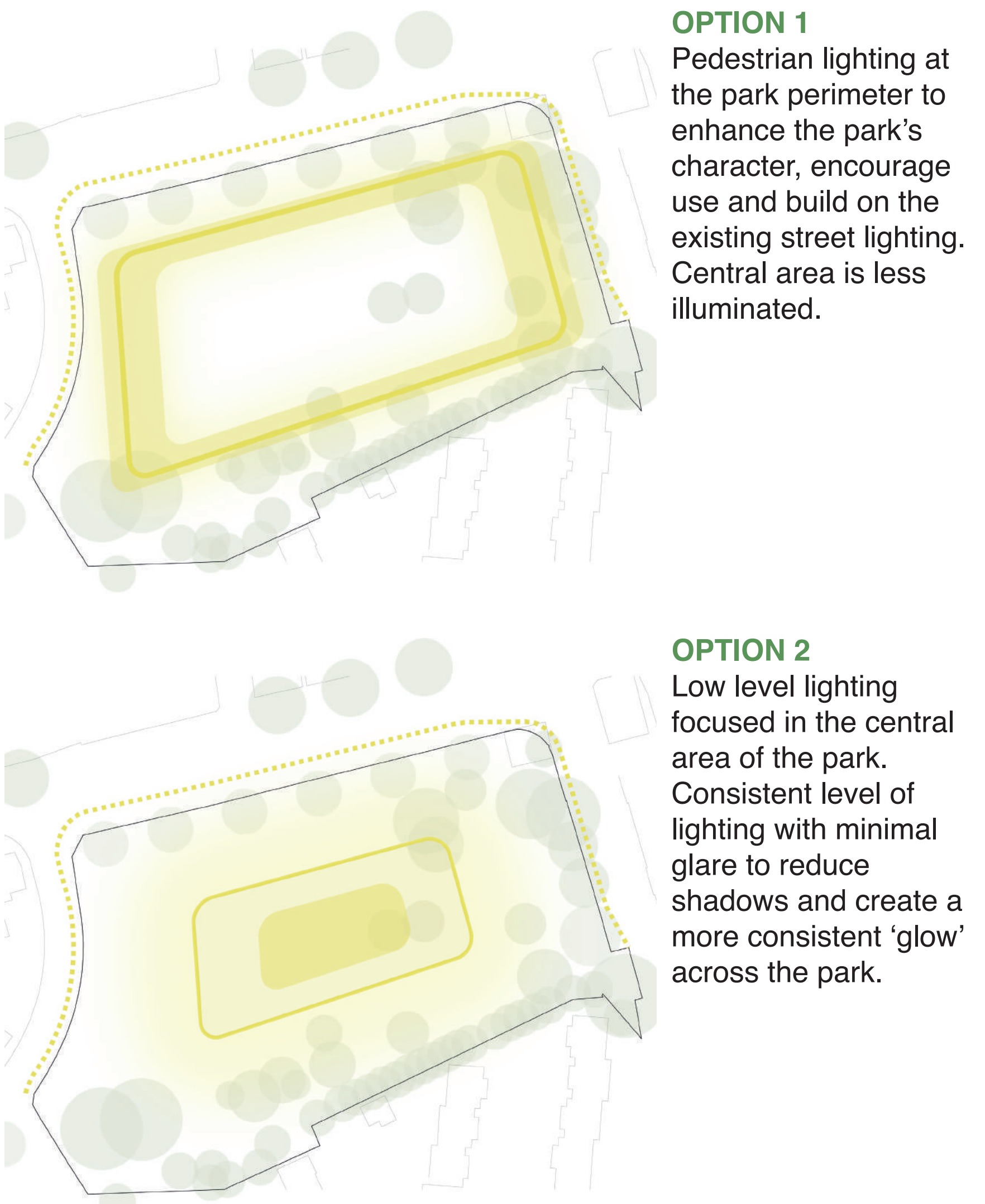

OPTION 1
Pedestrian lighting at the park perimeter to enhance the park's character, encourage use and build on the existing street lighting. Central area is less illuminated.

OPTION 2
Low level lighting focused in the central area of the park. Consistent level of lighting with minimal glare to reduce shadows and create a more consistent 'glow' across the park.

OPPORTUNITIES TO DEFINE DEAN GARDENS:

ACTIVATING THE PARK AND IMPROVING SECURITY



CANOPY LIFTING
Normand Park before. Dark, poor visibility.



CANOPY LIFTING
Normand Park after. Light, good visibility and retention of important trees.



COMMUNITY GROWING
Help activate Leeland Terrace. Create community cohesion



ENSURING THERE IS SUFFICIENT OPEN SPACE
For events, festivals and fairs



DEFINE ENTRANCES
Create legible and characterful thresholds. Create a sense of arrival.



LIGHTING THE PARK
Ensuring suitable lighting throughout the park to encourage a night time economy

RE-IMAGINING PLAY IN THE PARK



EXISTING PLAYGROUND

- Very popular and well used
- "Tired and in need of an update"
- Urbanises the Park
- Does not fit into natural play category
- Play equipment is prescriptive
- Not a good relationship with the Willow Trees (although shade is important)
- Fragmented, unattractive surfaces which do not contribute to play value
- Collaborative play opportunities limited
- Landform not used for play
- Fencing limits scope of play



TIMBER
Play should make use of natural elements.



LANDFORM
Play should be non-prescriptive and help define the character of the park.



CLIMBING
Play should build in opportunities to experience risk and challenge.



SENSORY
Successful play stimulates the five senses, providing access to music and sound, and different smells made by plants and leaves.



CROSS GENERATIONAL
Cross generational play avoids territorialisation of space. Play should avoid segregating children on the basis of age or ability



PLAY INTO SPORT
Encouraging a route to sport through play. Play should allow children to develop skills and coordination.

BUILD A CYCLE AND WALKING CULTURE

- The Mayor's Transport Strategy sets out a vision for making walking, cycling and public transport the most appealing and practical choice for 80% of journeys in London by 2040.
- This is a TFL LN Funded scheme so cycling is at the core of the project.
- A cycle route is the minimum - Can we build a cycle culture in Dean Gardens?

