

HELP SHAPE THE FUTURE OF DEAN GARDENS

INTRODUCTION

Dean Gardens in West Ealing is changing. As part of the West Ealing Liveable Neighbourhoods project, **Ealing Council** and **TfL** are undertaking ambitious improvements to the park, encouraging active travel and making the park a safer, greener, and more enjoyable space. **Kinnear Landscape Architects** and **New Practice** have been commissioned by Ealing Council to design and facilitate the transformation of **Dean Gardens**. The following boards present our initial findings and concept design options which we want your feedback on. We want the design of the park to be a collaboration with the people that will use it to ensure it is well loved and well used.

OPPORTUNITIES AND CONSTRAINTS - WIDER CONTEXT AND W.E.L.N.

This drawing looks at Dean Garden's wider context and the opportunities and constraints associated with its boundaries and connections.

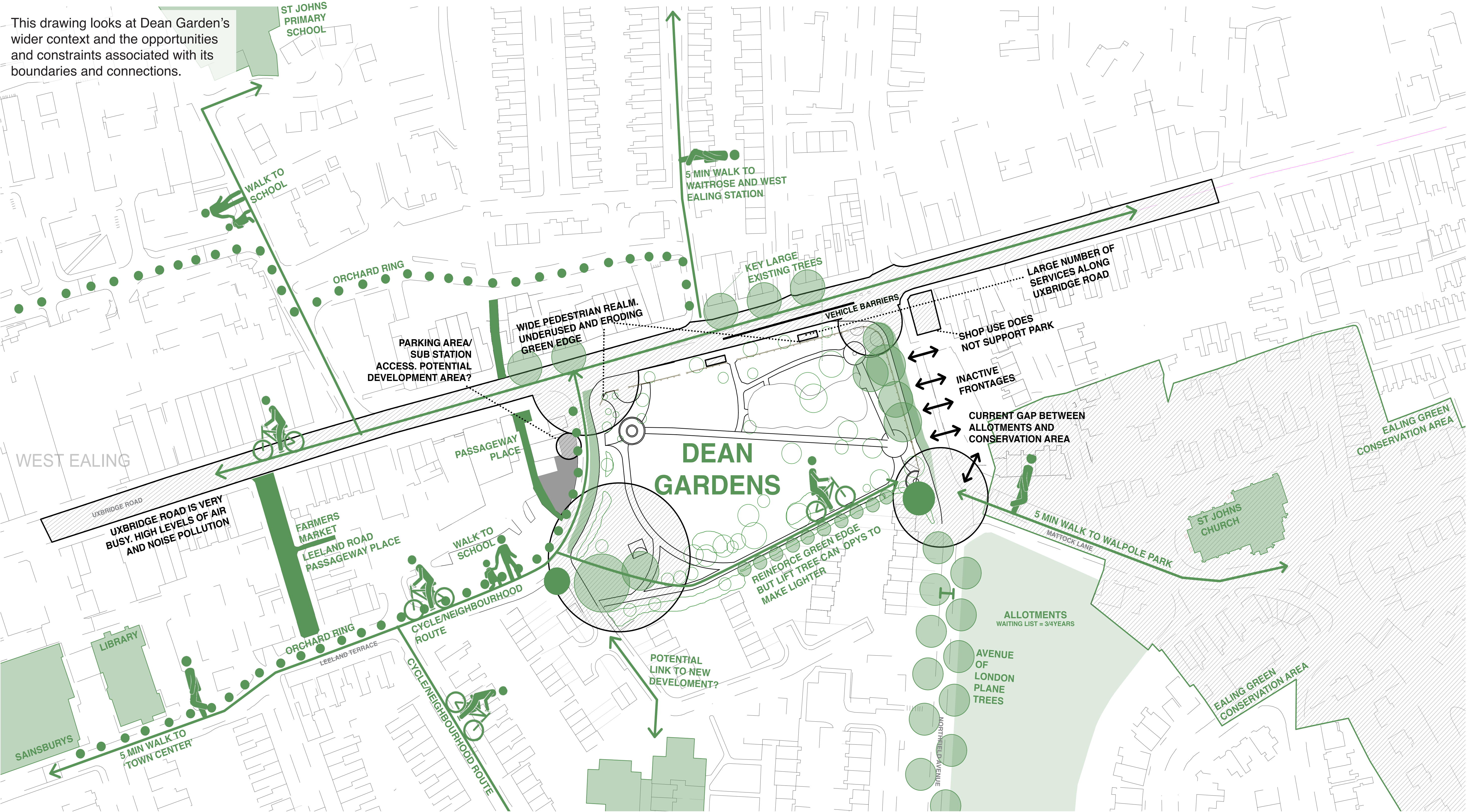

INCREASING TREE CANOPY COVER AND PLANTING



CONTRASTING SCALE
Surrounding Large trees. Dean Gardens side needs to match this.



FOREST SCALE TREES
Proposals should add to Existing Network
Help Reduce Pollution - WELN Objective



SUSTAINABLE DRAINAGE
Making the Park's green presence felt.
Ecology of the park effects urban realm.
Reducing noise and air pollution.

IMPROVING THE LEGIBILITY OF THE PARK



VIEW FROM CONSERVATION AREA
Park's Green Presence not felt
Potential to create green envelope around old allotment



VIEW TOWARDS CONSERVATION AREA
Green Context
High Quality Materials and Detailing



NORTHFIELD AVENUE
Inactive frontages could have uses to support the park?

ADDRESSING THE BROADWAY - AN IMPORTANT BOUNDARY



EROSION OF GREEN SPACE
Can this be taken back into the Park?



DOMINANT SERVICES
Visual and Physical Clutter



UNDER USED EDGE
Important consideration
Permeability Vs Buffer?

IMPROVING THE PARKS BOUNDARIES

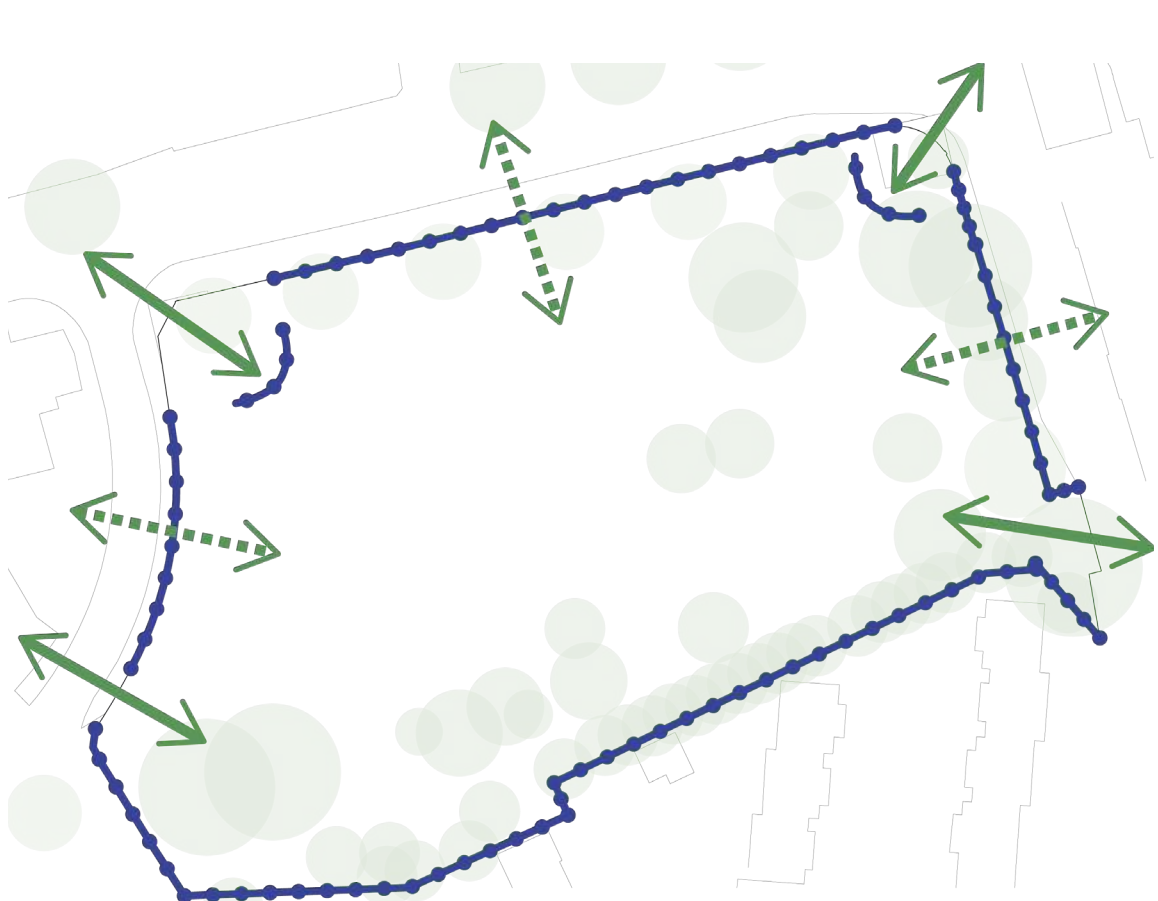

OPTION 1
Retaining existing fencing. As it currently is or introduce a new low fencing. This boundary is currently not a good buffer to noise and air pollution. Moderate physical permeability.

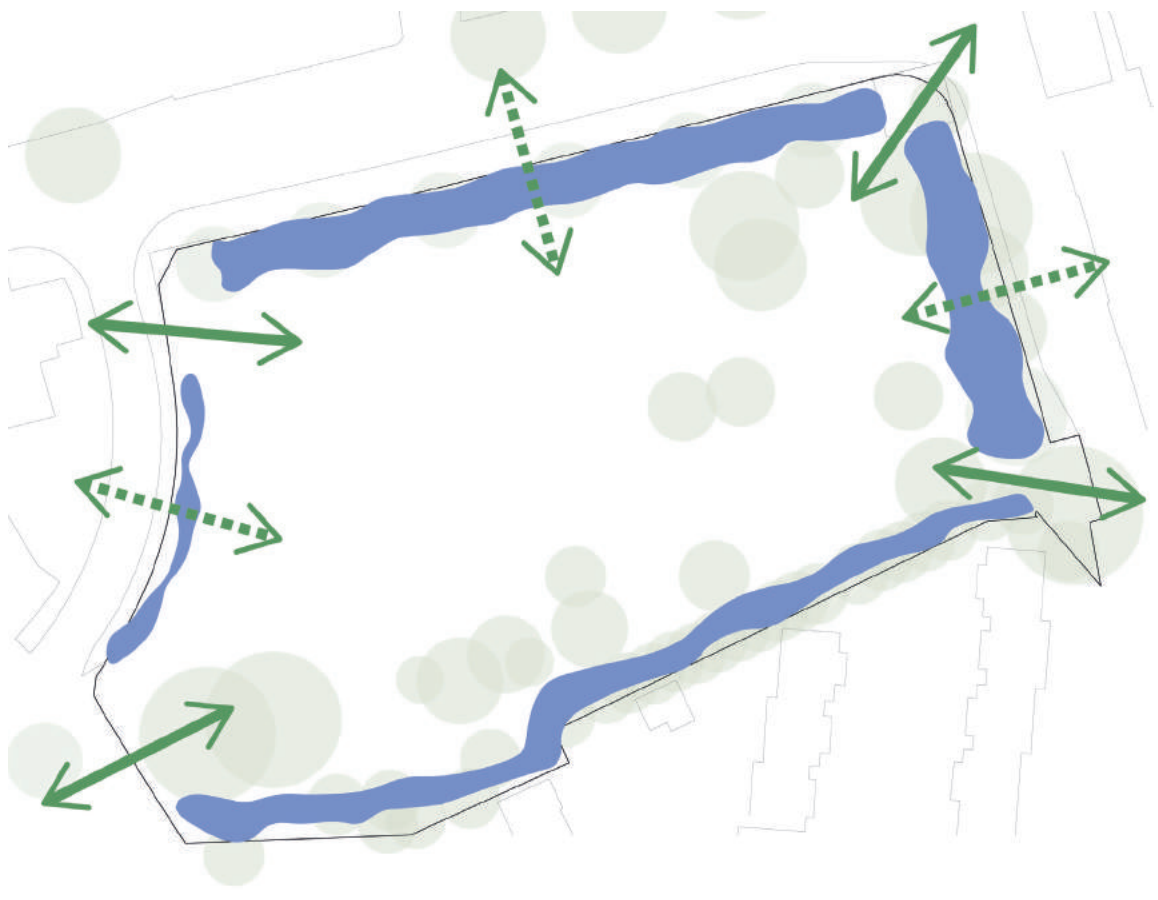

OPTION 2
Remove fencing and create new boundary using attractive low planting. Create barrier to movement and pollution but allow visual permeability. Benefit to Ecology and nature.

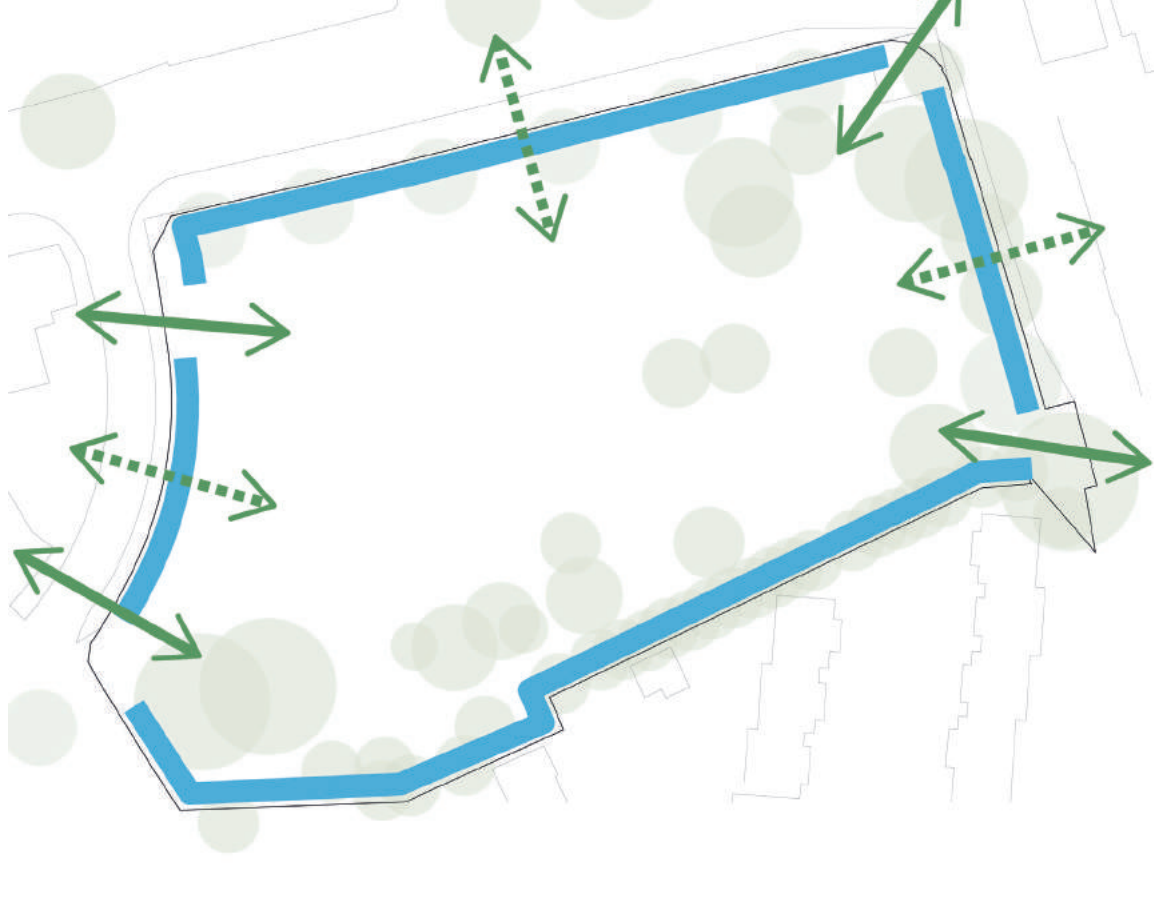

OPTION 3
Remove fencing and create new boundary using low seating wall. Create barrier to movement but allow visual permeability. No reduction in air and noise pollution. Edge can be activated.

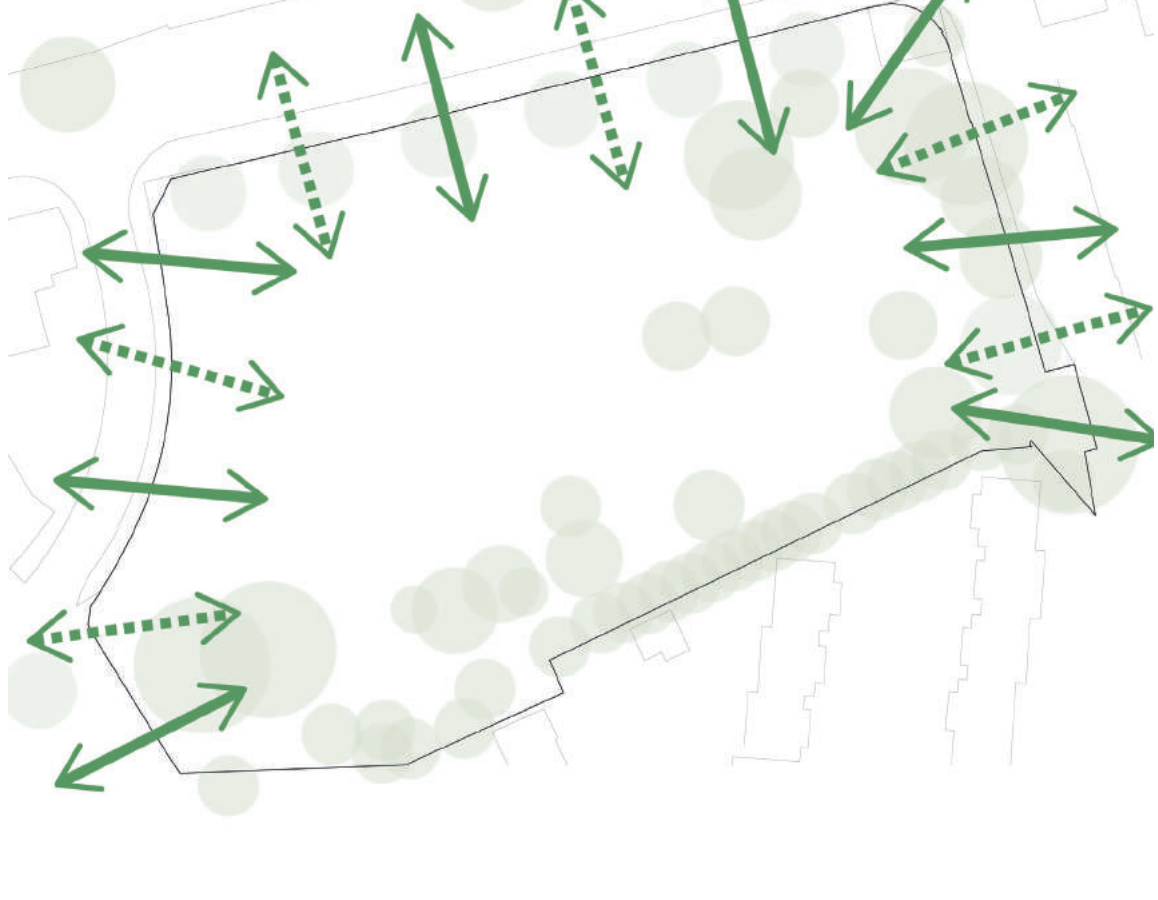

OPTION 4
Remove fencing have park boundary completely open. Full physical and visual permeability. No reduction in air and noise pollution. Park feels part of Uxbridge Road.

